

Swivel castor QD 250 CIB

Extra Heavy Duty Series QD - Wheel Q

-30 °C - +80 °C

+++
swivels easily

+++
wear resistant

+++
shock proof

+
floor protective

+++
weather proof

Wheel



Casted iron wheel, painted, round machined tread

Fork



Pressed steel welded construction,
with axial ball bearing and tapered roller bearing,
dust protection ring,
very strong integrated Kingpin,
grease nipple,
wheel axle with self-locking nut finish: zinc plated

Swivel castor	Wheel-Ø A x width B mm: 250x51
Load Capacity kg:	1200
Load capacity tested according to EN 12530 and EN 12527	
Overall height H mm:	300
Dimension of top plate TP mm:	150x110
Hole spacing HS mm:	105x80/121x59
Hole-Ø HD mm:	12,5
Swivel radius SR mm:	197
Wheel bearing:	Roller bearing

Advantages

- ✓ easy running on smooth floors
- ✓ very high load capacity
- ✓ excellent abrasion resistance
- ✓ with plain or ball bearing for high temperatures

©Copyright 2024 Rollenbau GmbH, www.rollenbau.at 20.05.2024

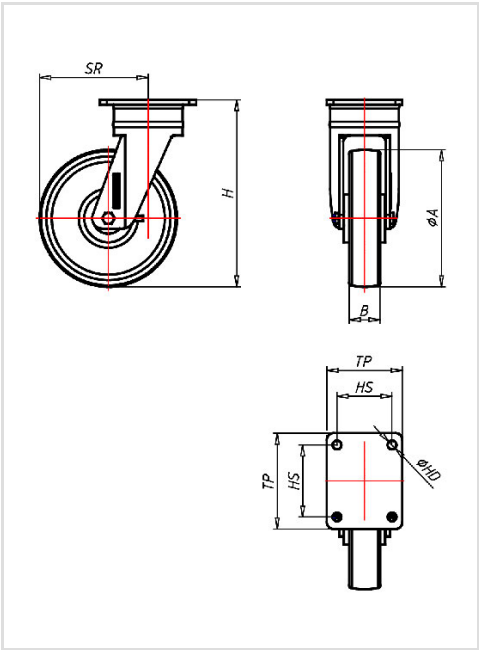

Applications

- Heavy duty dollies
- Trash container trucks
- Machinery moving dollies
- Racks